

# MARION TOWNSHIP SECTION 3 R12 TWP 8 MORGAN COUNTY, OH

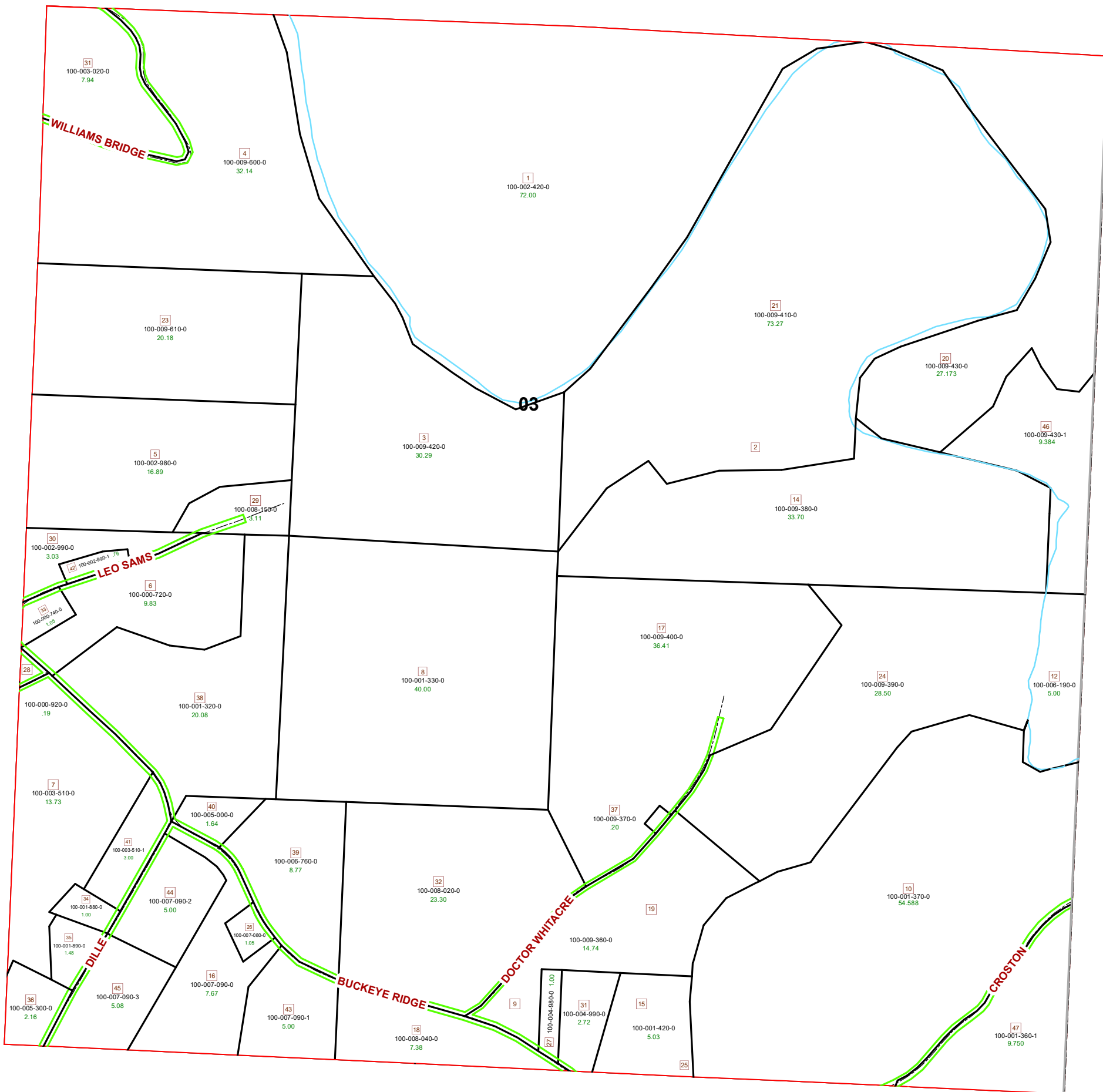

PIN	Owner	VOL	PAGE	LegalDescr	Acres
100-001-360-1	ALSUP MATTHEW R & TRACI D	OR228	1506	R12 T08 S03 SD 47 SU	9.75
100-009-610-0	BEHMAN RONALD & ELEANOR MAY	OR17	560	R12 T08 S03 SD 23 SU	20.186
100-009-600-0	BEHMAN RONALD & ELEANOR MAY	OR17	560	SD 4 SURVIVORSHIP	32.142
100-003-510-0	CLIPPINGER STEVEN L & JENNIFER J	OR122	66	R12 T08 S03 SD 7 SUR	13.73
100-009-430-0	COX & MILLER LLC	OR224	2679	R12 T08 S03 SD 20	27.173
100-001-370-0	CROSTON LARRY	OR228	1467	R12 T08 S03 SD 10	54.588
100-001-330-0	CROSTON WILLIAM E & MARCIA A	D.V 180	621	R12 T08 S03 SD 8 SUR	40
100-001-320-0	CROSTON WILLIAM E & MARCIA A	D.V 180	621	R12 T08 S03 SD 38 SU	20.088
100-001-420-0	DALTON HAROLD I & ROSA L	D.V 128	1	R12 T08 S03 SD 15-25	5.03
100-001-880-0	FLOWERS BONNIE SUE	D.V 193	217	R12 T08 S03 SD 34	1
100-002-420-0	HERSHBERGER JOE & VERNA	OR14	588	R12 T08 S03 SD 1 PAR	72
100-007-090-3	HILL DAVID LEE	OR213	830	R12 T08 S03 SD 45	5.086
100-007-090-2	HILL DAVID LEE	OR213	830	R12 T08 S03 SD 44	5.004
100-003-510-1	HILL DAVID LEE	D.V 198	781	R12 T08 S03 SD 41	3
100-002-990-0	HILL HARLEY LEON & CAROLYN S	OR53	433	R12 T08 S03 SD 30 SU	3.035
100-002-980-0	HILL HARLEY LEON & CAROLYN S	OR53	433	R12 T08 S03 SD 5 SUR	16.89
100-003-020-0	HILL HARRY LEE & PATRICIA ANN	OR138	749	R12 T08 S03 SD 31	7.94
100-000-740-0	HILL TIMOTHY L	OR208	885	R12 T08 S03 SD 33	1.054
100-000-720-0	HILL TIMOTHY L	D.V 186	447	R12 T08 S03 SD 6	9.838
100-009-420-0	HUNT & FISH PROPERTIES LLC	OR229	563	R12 T08 S03 SD 3	30.62
100-009-410-0	HUNT & FISH PROPERTIES LLC	OR229	563	R12 T08 S03 SD 2-21	73.277
100-002-990-1	JONES JOSEPH B & TRINA L	OR53	307	R12 T08 S03 SD 42 SU	0.765
100-004-990-0	MAYLE BRUCE A	OR232	4741	R12 T08 S03 SD 31	2.72
100-004-980-0	MAYLE BRUCE A	OR232	4741	R12 T08 S03 SD 27	1
100-005-300-0	MAYLE RONALD D	D.V 166	618	R12 T08 S03 SD 36	2.16
100-001-890-0	MAYLE RONNIE & SHERYL	OR22	178	R12 T08 S03 SD 35 SU	1.48
100-007-090-1	NICHOLS JEFFERY & KELLY S FLOWERS	OR93	128	R12 T08 S03 SD 43 SU	5
100-007-080-0	PIRES PATRICK W & GLORIA A	OR94	119	R12 T08 S03 SD 26 SU	1.05
100-007-090-0	PIRES PATRICK W & GLORIA A	OR94	119	R12 T08 S03 SD 16 SU	7.67
100-006-760-0	PIRES PATRICK W & GLORIA A TRUSTEES	OR94	119	R12 T08 S03 SD 39	8.77
100-005-000-0	PIRES PATRICK W & GLORIA A TRUSTEES	OR94	119	R12 T08 S03 SD 40	1.64
100-006-190-0	SCHENKENBERGER RAYMOND J & CAROLYN J	D.V 206	491	R12 T08 S03 SD 12	5
100-009-430-1	SCHENKENBERGER RAYMOND J & CAROLYN J	OR224	3422	R12 T08 S03 SD 46 SU	9.384
100-008-040-0	STARLING NANCY ANN TRUST STARLING ROBERT STANLEY	OR225	2364	R12 T08 S03 SD 18	7.38
100-009-360-0	STARLING NANCY ANN TRUST STARLING ROBERT STANLEY	OR225	2364	R12 T08 S03 SD 9-19	14.74
100-008-020-0	STARLING NANCY ANN TRUST STARLING ROBERT STANLEY	OR225	2364	R12 T08 S03 SD 32	23.3
100-009-390-0	STARLING NANCY ANN TRUST STARLING ROBERT STANLEY	OR225	2364	R12 T08 S03 SD 24	28.5
100-009-400-0	STARLING NANCY ANN TRUST STARLING ROBERT STANLEY	OR225	2364	R12 T08 S03 SD 17	36.411
100-009-380-0	STARLING NANCY ANN TRUST STARLING ROBERT STANLEY	OR225	2364	R12 T08 S03 SD 14	33.7
100-008-150-0	STEVENS ELIZABETH ANN	OR223	3469	R12 T08 S03 SD 29	3.11
100-000-920-0	TABLER RHONDA L & EMMET L COOK	OR202	1253	R12 T08 S03 SD 28	0.19
100-009-370-0	WHITACRE CEMETARY BY ASIA H & LENA M WHITACRE	D.V 160	749	R12 T08 S03 SD 37	0.209

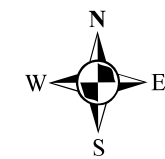

Boundaries	
----- Hidden	--- ROW
----- Hydro	--- Section
----- Roads	--- Township
----- County	--- Parcels
----- Lot	---
----- Parcel	---



Disclaimer: The information that these maps contains is for reference purposes only. Please bring any erros to the attention of the Engineer's Office staff.  
Thank you

Source: Morgan County Engineer's Office  
Author: Marcia Wolfe  
Date: 7/1/2020

